



# INSTALLATION INSTRUCTIONS

## MODEL: CDI ASSEMBLY

Inline Panel Pack for Cardinal Series Continuous Hinge Swing Door

When ordering repair parts, please provide the following information:

1. Model Number
2. Part Number
3. Part Description
4. Finish Color

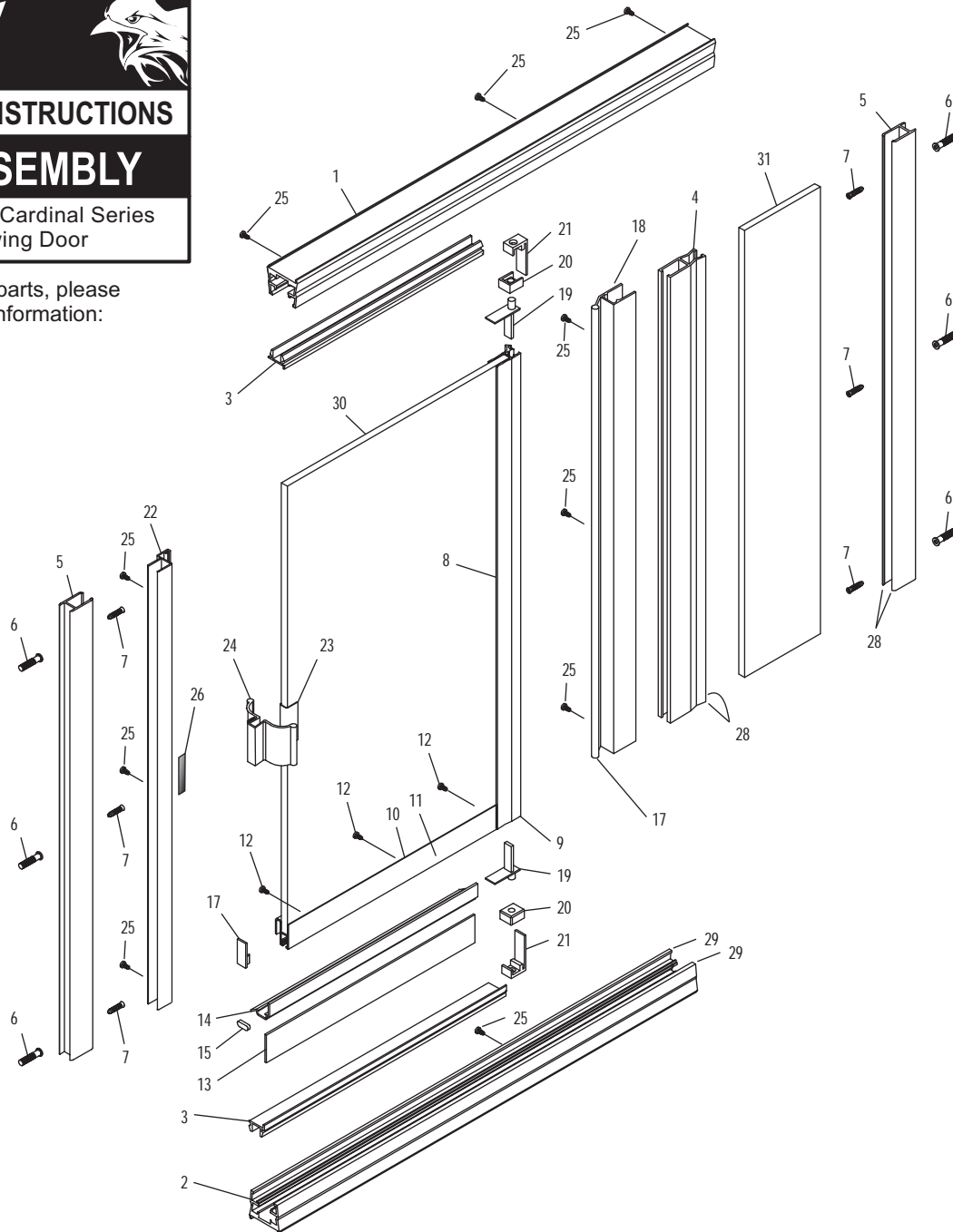

DESCRIPTION	QTY	PART NO.	PICTURE
1. Header	1	ZSS-3101	
2. Curb	1	ZSS-3101	
3. Header and Curb Filler	2	ZSS-1102	
4. Inline Post	2	ZSS-1103	
5. Wall Channels	2	ZD-1006	
6. Wall Anchors	6	ZV-935	
7. #8 x 1-1/4" Screws	6	#8x1-1/4"	
8. Glazing Vinyl	1	ZV-925	
9. Hinge Rail with Vinyl	1	ZD-2503	
10. Glazing Vinyl for Bottom Rail	1	ZV-903	
11. Bottom Rail	1	ZD-1002	
12. #6 x 1/4" Screws	3	#6x1/4"	
13. Splash Vinyl	1	ZV-904	
14. Drip Trough	1	ZD-1008	
15. Drip Plug	1	ZV-905	
16. Bottom Rail End Cap	1	ZV-940	
17. Hinge Jamb Sleeve Vinyl	1	ZV-955	
18. Hinge Jamb	1	ZD-2505	
19. Hinge Pins	2	ZV-945	
20. Hinge Bushings	2	ZD-1013	
21. Hinge Clips	2	ZD-1009	
22. Lange Jamb with ZV908 Vinyl	1	ZD-1004	
23. 3" Handle Vinyl	1	ZV-91	
24. 3" Door Pull	1	ZD-2011	
25. #6 x 3/8" Screws	10	#6x3/8"	
26. Magnetic Strip Clasp	1		
27. Glass Support Blocks	1	ZV-902	
28. Vertical Seal Vinyl	4	ZV-909	
29. Horizontal Seal Vinyl	4	ZV-906	
30. Door Glass	1		
31. Inline Glass Panel	1		
<b>Optional Magnetic Catch</b>			
32. 3" Magnetic Door Pull	1	MAG 4011-3	
33. Mag Channel	1		
34. #6 x 1/4" Screws	2	#6x1/4"	

CDI Assembly Diagram