



# INSTALLATION INSTRUCTIONS

MODEL: **C-Pack 90-36**

Return Panel Pack for Cardinal Series  
Continuous Hinge Swing Door

When ordering repair parts, please provide the following information:

1. Model Number
2. Part Number
3. Part Description
4. Finish Color

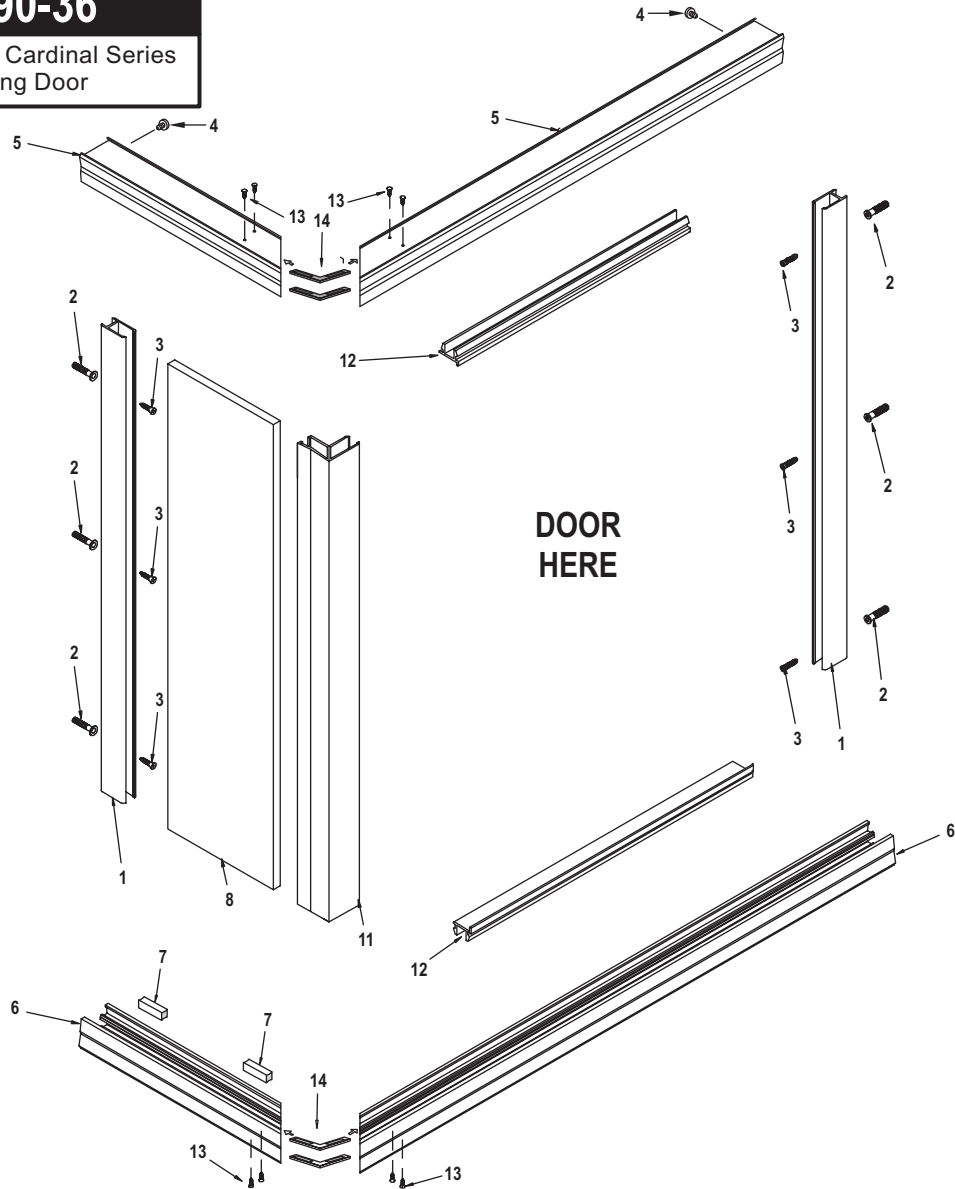

DESCRIPTION	QTY	PART NO.	PICTURE
1. Wall Channels*	2	ZD-1006	
2. Wall Anchors*	6	ZV-935	
3. #8 x 1-1/4" Screws*	6	#8X1-1/4	
4. #6 x 3/8 Screws	10	#6X3/8	
5. Headers	2	ZSS-3101	
6. Curbs	2	ZSS-3101	
7. Glass Support Blocks	2	ZV-902	
8. 90 Degree Glass Panel	1		
9. Vertical Seal Vinyl	4	ZV-909	
10. Horizontal Seal Vinyl	4	ZV-906	
11. 90 Degree Corner Posts	1	ZSS-1104	
12. Header and Curb Fillers	2	ZSS-1102	
14. 90 Degree Header/Curb Clips	4	ZC-90	

\*Note: Items 1, 2 and 3 come with door stall wrap

**REQUIRED TOOLS**

To install your shower enclosure, you will need the following:

- Level
- #31 Drill Bit
- 3/16" Carbide Drill Bit ( for tile walls)
- Phillips Screwdriver
- Silicone
- Hack Saw
- 1/4" Box End Wrench

NOTE: Wall channels (1), wall anchors (2) and screws (3) that are used in stall shower installation are shipped with the shower door. Read both door and stall instructions before starting installation.

1. Add 1/2" to centerline measurement and cut curb to length.
2. Assemble curb with clips provided (Figure 1). Using holes provided in header and curb, secure using eight #6 x 3/8" SMS Screws (4). Set curb in place and mark location on curb leaving curb in place temporarily.
3. Set wall channels into curb and mark holes on wall. Remove wall channel and drill holes into wall using 3/16" drill. Place plastic screw anchors into holes.
4. Run a 1/4" bead of silicone on underside of curb, inside miter and where the ends of the curb are on the threshold.
5. Replace curb and silicone where miters are, and where curb meets wall. Replace the wall channels and secure using #8 x 1 1/4" SMS.
6. Place glass support blocks in curb and set 90-degree panel in place, tacking at top with about 6" of the vertical seal vinyl. To adjust for wall conditions, adjust the panel in or out of the post, making sure that at least 1/4" remains in each channel.
7. Place corner post in place on other edge of glass and tack in place using vertical seal vinyl.
8. Check the chart for the door size, and obtain the range for the curb filler. If the distance between the wall channel and the corner post falls within this range then cut curb filler to size. If the measurement does not fall into the range, then a larger or smaller door is needed. Cut curb filler to size and snap in place with higher lip to outside of unit.

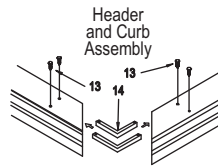
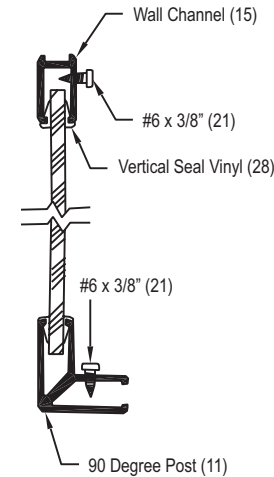
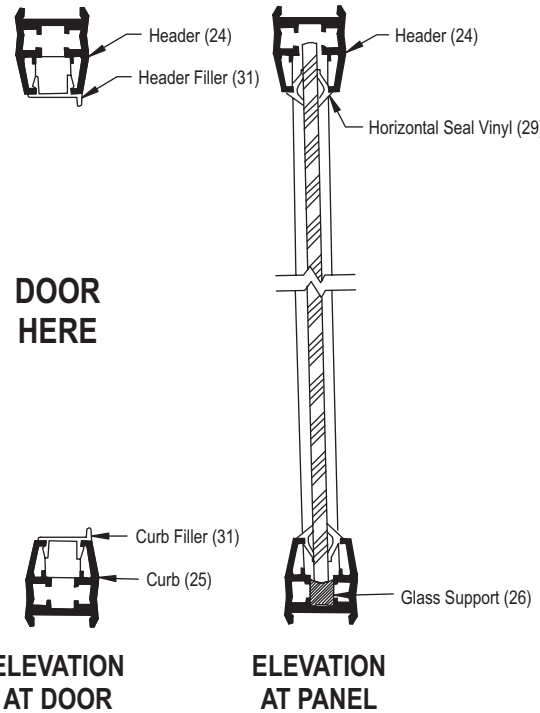

Figure 1

**(Refer to Shower Door Instructions...)**

9. Snip excess vinyl from latch jamb, and crimp in place at top and bottom. Holding corner post, slip latch jamb into place.
10. Install 3" vinyl channel, centered on edge of glass and tap handle into place.
11. Set door (with hinge jamb attached) over wall channel. Door with hinge clip should be resting on curb filler.
12. Move the corner post and latch jamb in or out at the top of stationary panel until they align themselves with the glass.
13. **DO NOT MOVE FROM THE POSITION OF THE STATIONARY PANEL GLASS IN STEP #12,** because that determines the measurement of the header over the panel. Plumb the corner post to the door wall and measure from the corner post to the wall over the door. This determines the measurement of the header over the door. Add 1/4" to each of these measurements and cut the header and assemble. Place header in place and recheck alignment. If the alignment is good secure to wall channels and corner post. Snap header filler in place with lip to outside of unit.
14. Complete the installation of the vertical and horizontal seal vinyl.
15. Recheck alignment. If anything has moved, tape post to adjust. Adjust latch jamb for good fit. Use a #31 drill and #6 x 3/8" SMS to secure to latch post.
16. Adjust splash vinyl so that approximately 1/8" daylight space remains between bottom of splash vinyl and curb filler with the door in a closed position.
17. Install box catch on latch jamb.
18. Seal along inside and outside edge of metal and tile with silicone.

Header & Curb Fillers		
Min Filler = Door Size - 1 7/8"		
Max Filler = Door Size - 1 7/8"		
CD-20	18 1/8"	19 1/8"
CD-21	19 1/8"	20 1/8"
CD-22	20 1/8"	21 1/8"
CD-23	21 1/8"	22 1/8"
CD-24	22 1/8"	23 1/8"
CD-25	23 1/8"	24 1/8"
CD-26	24 1/8"	25 1/8"
CD-27	25 1/8"	26 1/8"
CD-28	26 1/8"	27 1/8"
CD-29	27 1/8"	28 1/8"
CD-30	28 1/8"	29 1/8"
CD-31	29 1/8"	30 1/8"
CD-32	30 1/8"	31 1/8"
CD-33	31 1/8"	32 1/8"
CD-34	32 1/8"	33 1/8"
CD-35	33 1/8"	34 1/8"
CD-36	34 1/8"	35 1/8"



Plan View

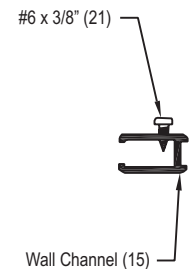

**Cardinal**  
SHOWER ENCLOSURES



## INSTALLATION INSTRUCTIONS

MODEL: **C-Pack 90-36**

Return Panel Pack for Cardinal Series  
Continuous Hinge Swing Door

# Frameless Enclosures

Model CD 90 36 Stall Shower - 90 Degree Panel & Door

## Breakdown Chart for Special Height and Width CD 90 36 Units

QTY.	Part# & Description	How to arrive at measurement
1	ZSS 3101 Header	Unit width both sides
1	ZSS 3101 Curb	Unit width both sides
2	ZSS 1102 Filler	
1	ZSS 1103 180 Degree Post	Unit width minus 1 1/4"
2	ZD 1006 Wall Channel	Unit height minus 1 1/14" *
1	ZD 1004 Latch Jamb	Unit minus 2 3/8" *
1	ZD 2505 Hinge Jamb	Unit height 2 3/8" *
1	ZD 2503 Hinge Rail	Unit height 3 1/4" *
1	ZD 1002 Bottom Rail	Door glass width minus 11/16" *
1	ZD 1008 Drip Trough	Door glass width minus 3/16" *
	(see chart for door glass width)	
	*These parts are from a CD	
Panel Glass		
1	width	Unit width minus door width, minus 1"
	height	Unit height minus 1"

This page intentionally left blank